

# FLOE STANDARD SECTIONAL DOCK CLEAT ATTACHMENT KIT ASSEMBLY INSTRUCTIONS

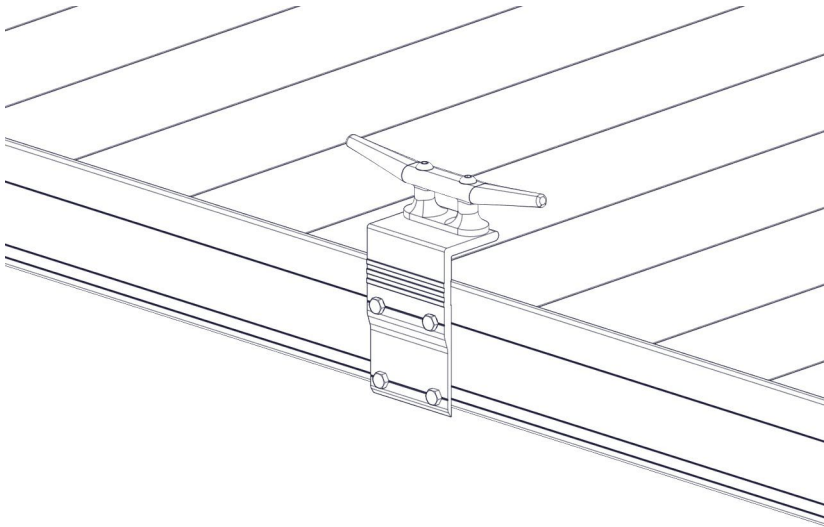

KIT P/N 510-02362-00



\*DOCK SECTION & LEGS NOT INCLUDED

**NOTE:**

CLEAT IS SOLD SEPARATELY.

## TOOLS REQUIRED

- (2) 9/16" SOCKETS/WRENCHES
- TAPE MEASURE
- TORQUE WRENCH
- FRAMING SQUARE
- MARKER
- CORDLESS DRILL
- 13/32" DRILL BIT
- HAMMER
- CENTER PUNCH

# BILL OF MATERIALS

P/N 510-02362-00		KIT, CLEAT MTG. HRDW. STD. SECTIONAL DOCK	
NUMBER	PART NUMBER	DESCRIPTION	QTY
1	001-70111-00	HHCS, 3/8-16 X 2" 18-8 SS	2
2	001-70112-00	HHCS, 3/8-16 X 2-1/4" 18-8 SS	2
3	001-71017-00	FLAT WASHER, 3/8" SAE SS 18-8	4
4	001-76071-00	NUT, NYLOCK 3/8-16 ALUM.	4

P/N 510-05360-01		CLEAT, CAST ALUM. 10" (NOTE: NOT INCLUDED WITH 510-02362-00)	
NUMBER	PART NUMBER	DESCRIPTION	QTY
5	110-00078-00	ASS'Y, CLEAT BRACKET 10" CAST ALUM	1
5A	001-37026-00	NUT, 3/8-16 JAM NYLOCK - ZINC	2
5B	001-73821-00	BHCS, 3/8-16 X 2-1/2" SS 18-8	2
5C	002-02532-00	ANGLE, DOCK CLEAT - 4"	1
5D	510-34300-00	DOCK CLEAT, 10" CAST ALUM	1

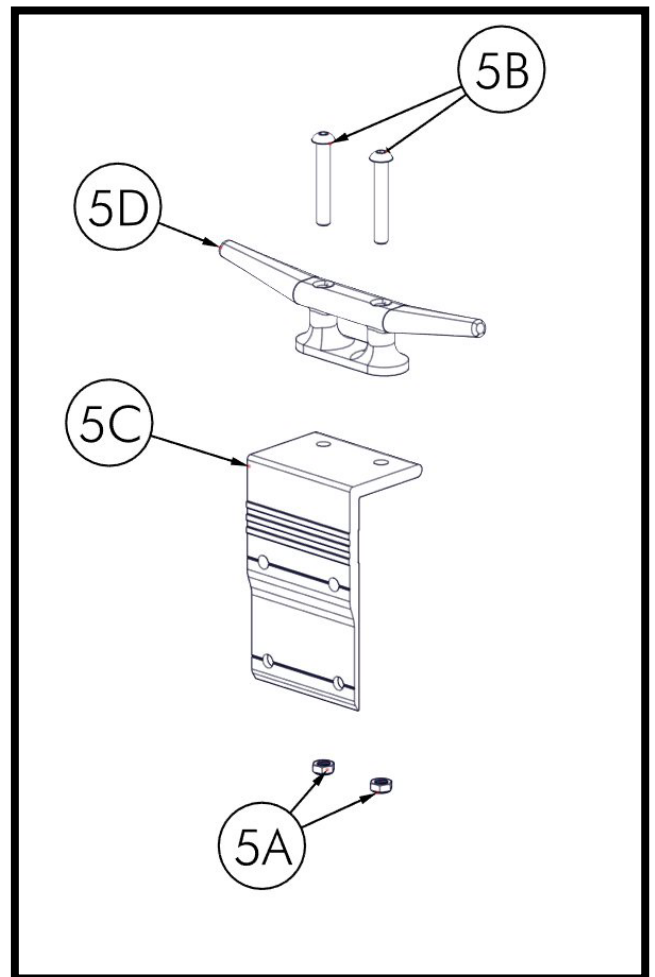
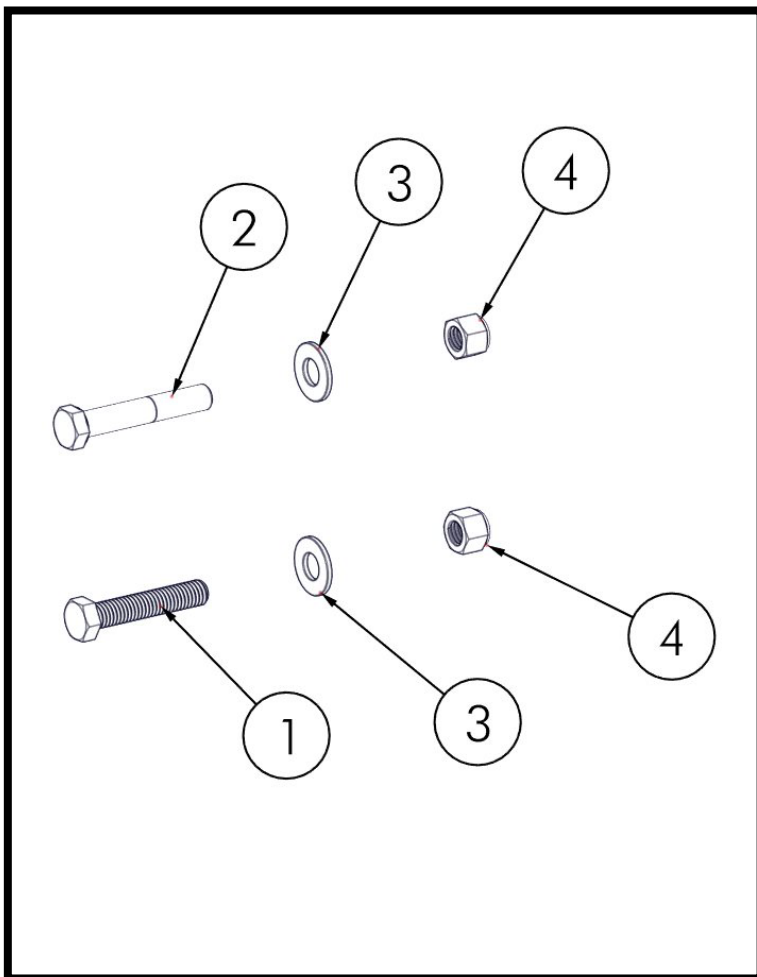

# ASSEMBLY

FIRST, DETERMINE WHERE THE CLEAT WILL BE INSTALLED ON THE DOCK SYSTEM. USING A FRAMING SQUARE, MARK A VERTICAL LINE ACROSS THE TOP AND BOTTOM SERRATIONS (THESE SERRATIONS ARE 3" APART AND ARE INTENDED TO ACT AS A HOLE SPACING REFERENCE). MARK A SECOND LINE 2-3/4" FROM THE FIRST LINE. USE A HAMMER AND CENTER PUNCH TO MAKE A DIMPLE FOR THE DRILL BIT. THIS HELPS PREVENT THE DRILL FROM WANDERING. KEEP THE DRILL BIT PERPENDICULAR TO THE DOCK FRAME WHILE DRILLING (FIGURE 1.1). INSERT (2) 3/8" X 2" BOLTS AND (2) 3/8" X 2-1/4" BOLTS INTO THE CLEAT BRACKET AND INTO THE DOCK SIDE (FIGURE 1.2).

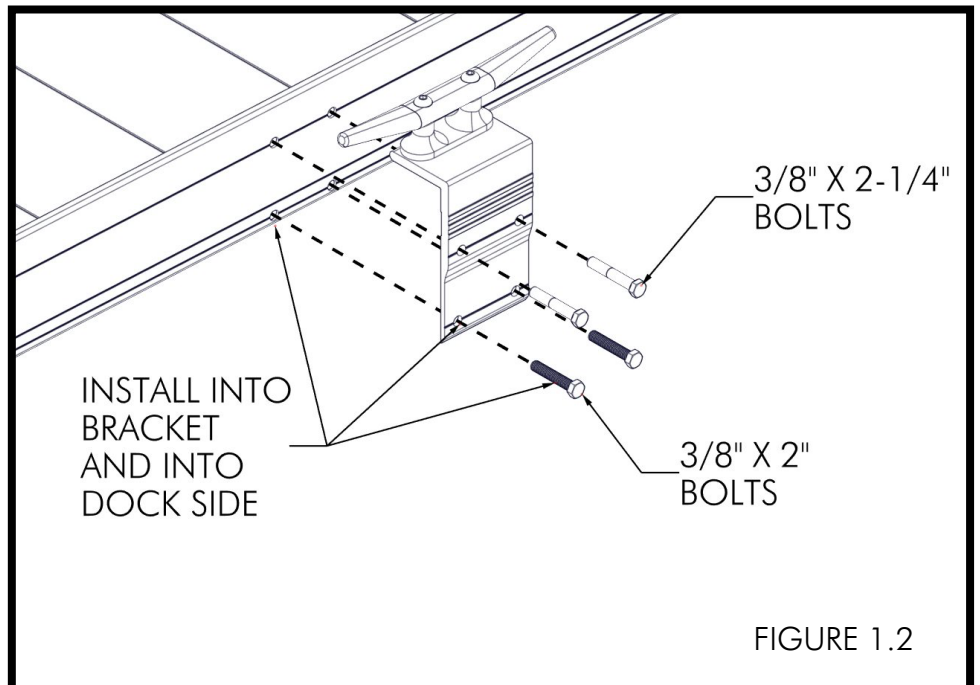
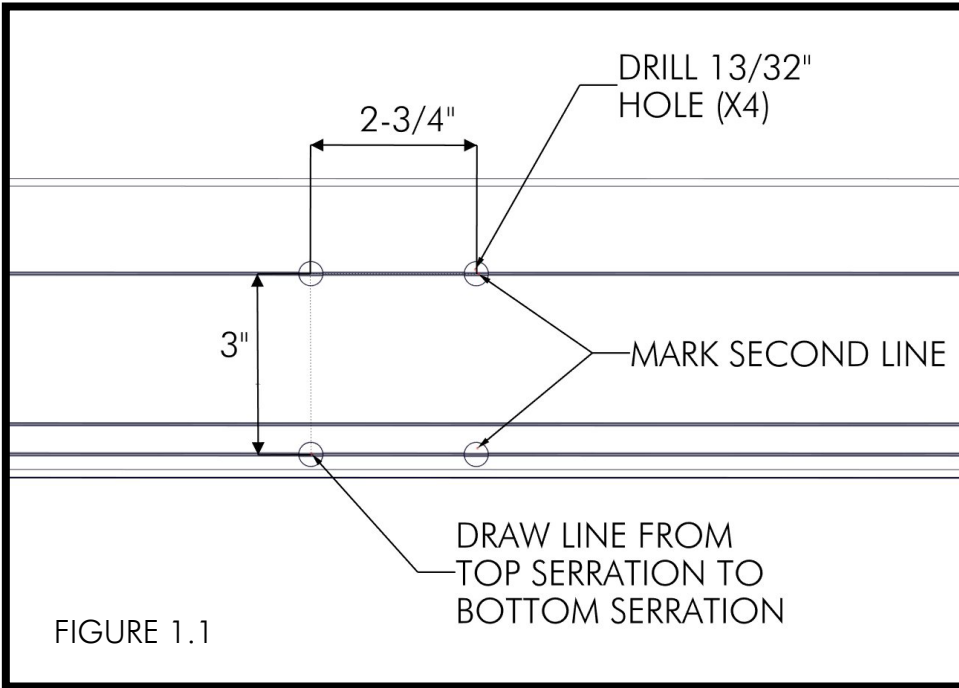

PLACE A 3/8" WASHER AND 3/8" NYLOCK NUT ONTO EACH BOLT (FIGURE 1.3). TORQUE ALL NUTS TO 40 FT-LB (FIGURE 1.4).

